

CHILDREN'S GARDEN TRAIL

Follow the numbers
1-12 on this map to
answer the questions.

Take care – after 600
years the paths and
steps are a little
uneven!

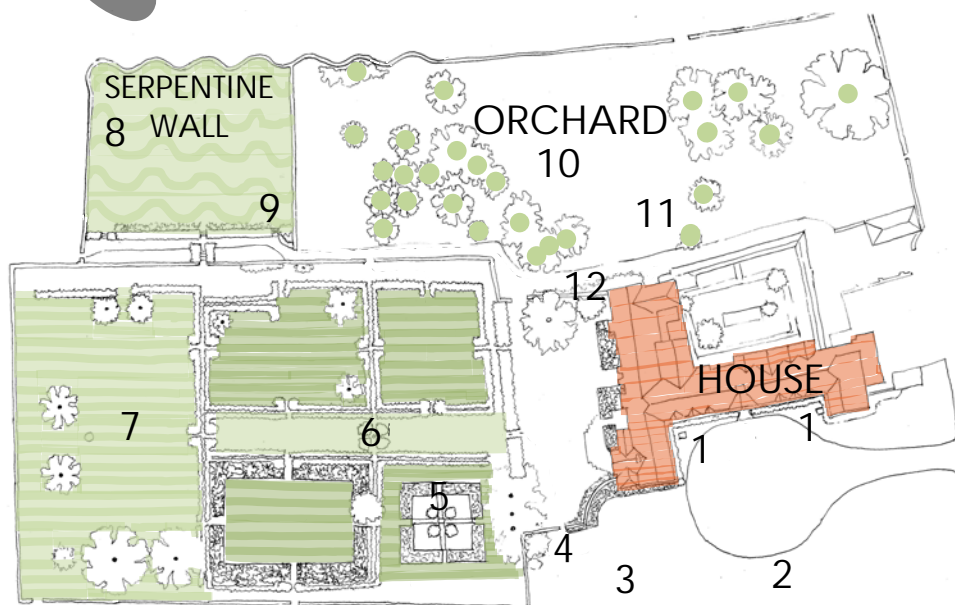

1 LITTLE BRICK HOUSES

What do you think these two small
houses were used for?

.....
The bowls in front might give you a
clue. One of them is round and the
other is an _ _ _ _ G O N



2 HOUSE WINDOWS

Stand in front of the house at
number 2 on the map. How
many windows can you
count?

3 BUILDING MATERIALS

West Horsley Place has been added to over the centuries, and many different materials
have been used. Tick the boxes when you spot any of them as you walk the grounds:

BRICK ☐ LEAD ☐ STONE ☐ TILE ☐ PEBBLE ☐ WOOD ☐ GLASS ☐

4 WROUGHT IRON GATES

There are many beautiful
examples of this type of gate
around the grounds.
Which craftsman makes items
from wrought iron?

IRONMONGER ☐

BLACKSMITH ☐ FORGER ☐



5 ROSE GARDEN

Unscramble the letters to find
the name of this tall structure
in the rose garden

V E O C T D E O

.....



6 PET BIRD EPITAPH

What was the name of the pet bird remembered here?

_ _ _ _ _

When did the bird live?
19 _ _ until 19 _ _



7 LOWER LAWN

Can you guess what game used to be played on this large lawn?

Cricket ☐

Tennis ☐

Croquet ☐



8 SERPENTINE WALL

Why do you think this wall is called 'serpentine'?

.....

Can you guess the other name for this type of wall?

CURLY WHIRLY TOPSY TURVEY

ZIGGY ZAGGY CRINKLE CRANKLE



9 MYSTERY OBJECT

You can find this object in the same area as the serpentine wall. Mark the place with an X. What do you think it is?

W _ _ _ _ P _ _ _



10 ORCHARD

Which fruit tree is not growing in the orchard?

MULBERRY ☐

PLUM ☐

PEAR ☐

ORANGE ☐

DAMSON ☐

APPLE ☐



11 ORCHARD SCULPTURES

These lovely sculptures of Don Quixote and Sancho Panza have been made from lots of objects that would otherwise have been thrown away. They are all made of

PLASTIC ☐

WOOD ☐

METAL ☐



Name three of the objects used:

.....

12 MATHEMATICAL TILES

Stand at 12 and look at the top section of bricks.

Are they the normal size or is there something odd about them? Look carefully at the edge!

.....

